

TR1G Eastbound

This map is reproduced from Ordnance Survey material with the permission of Ordnance Survey on behalf of the Controller of Her Majesty's Stationery Office © Crown copyright/Unauthorised reproduction infringes Crown copyright and may lead to prosecution or civil proceedings. Stockport Metropolitan Borough Council 100019571 2010

NOTES:

1. This drawing has been produced based on the latest MX highway model – Draft Design Freeze 7, as provided by the client.
2. This drawing has been produced mainly for the purpose of planning application.
3. Only one option has been considered for this location as per client's instructions.
4. Levels are in meters and above Ordnate Datum.
5. All dimension are in millimeters.
6. The option shown on this drawing is based on the latest available geotechnical information.
7. Basic preliminary design has been undertaken to determine the geometry of the section sizes as per client's instruction.

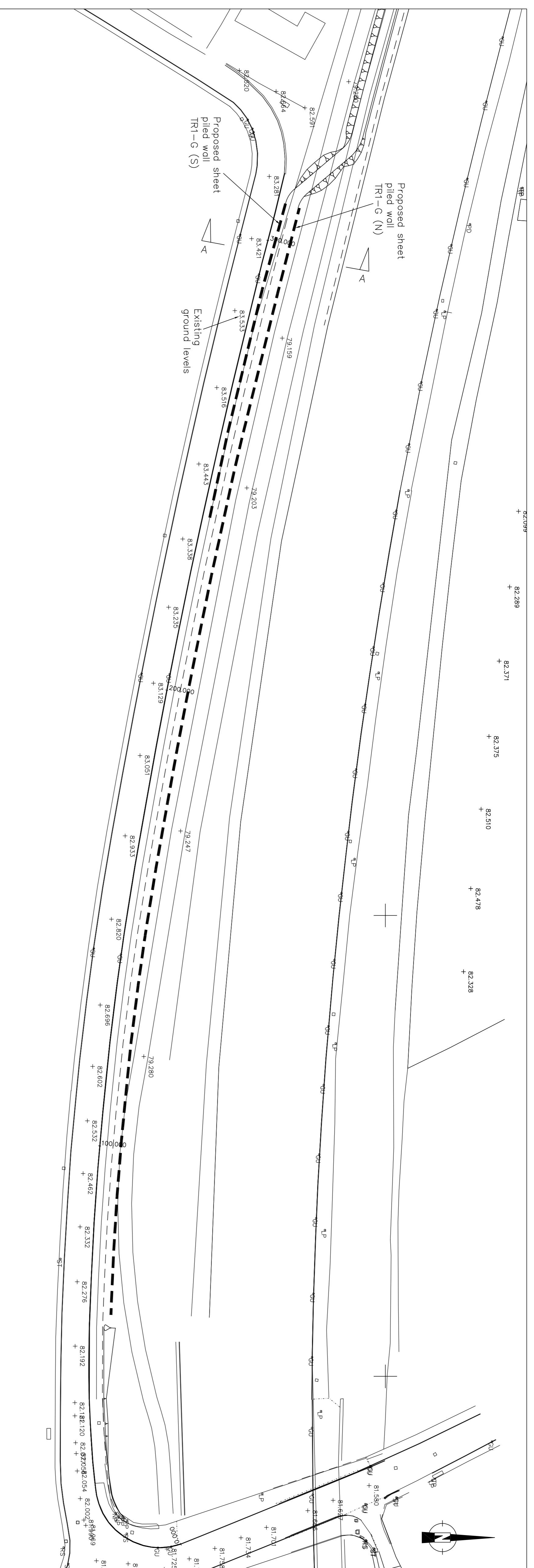

PLAN
SCALE 1:500

APPROXIMATE LENGTH OF WALL TR1-G (N): 244m
APPROXIMATE LENGTH OF WALL TR1-G (S): 70m

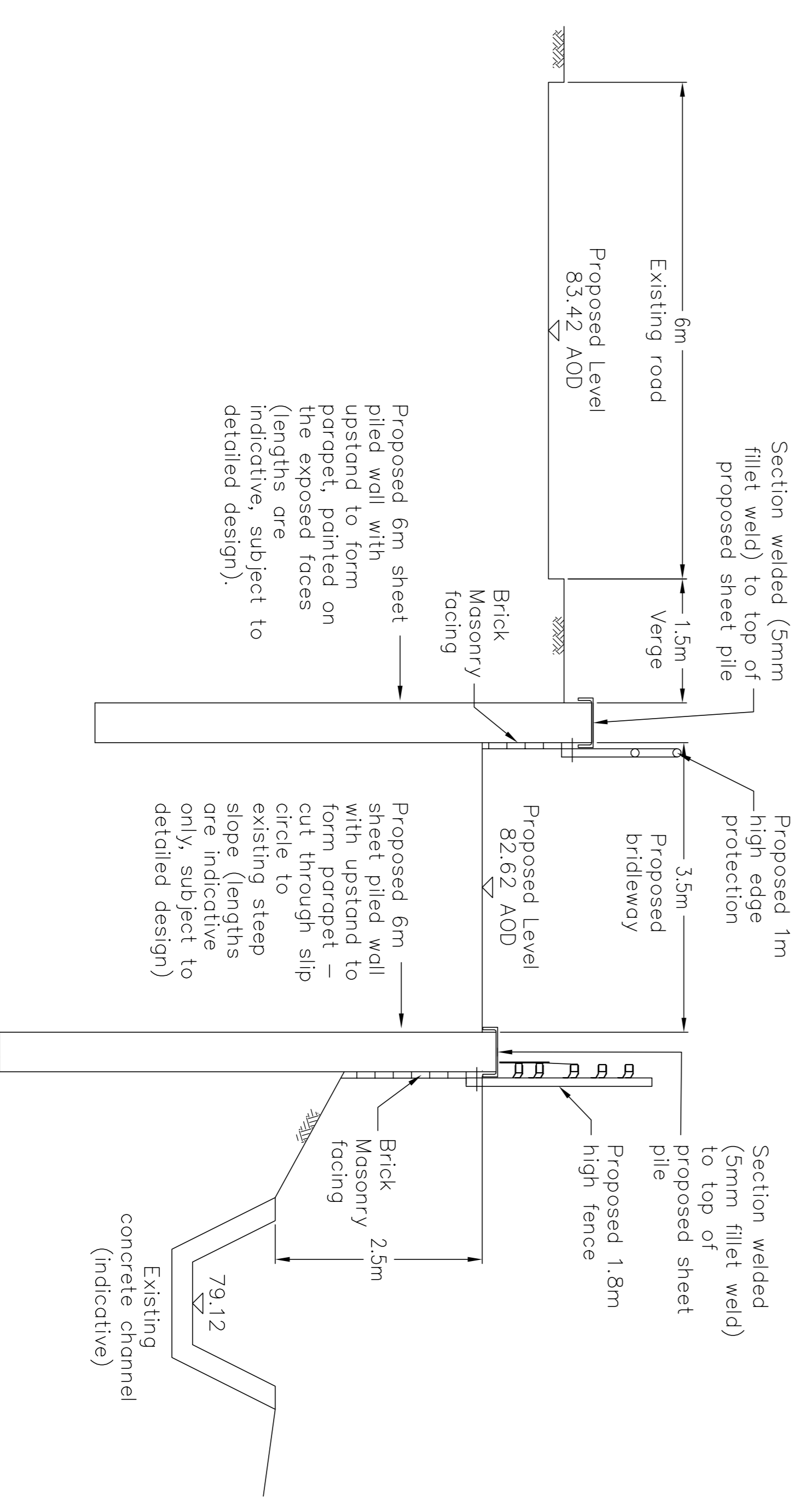

SECTION A-A
SCALE 1:50

Rev.	Drawn	Checked	Date	Revision Details
A	DB	ME	13/09/13	Issued for Planning
-	DB	ME	30/08/13	First Issue

Drawn	Engineer	Checked	Approved
DB	DJ	ME	NS
Date	Date	Date	Date
AUG/13	AUG/13	AUG/13	SEP/13

Size	Scale	Filename
A1	AS SHOWN	

SC60	Revision
1007/30/DF7/A6-MA/TR1G/006	A

Job Title	Client
A6 TO MANCHESTER AIRPORT RELIEF ROAD	MANCHESTER METROPOLITAN BOROUGH COUNCIL

Job Title	Client
A6 TO MANCHESTER AIRPORT RELIEF ROAD	MANCHESTER METROPOLITAN BOROUGH COUNCIL